

LX-PA

POSITION TRANSDUCER

INSTALLATION GUIDE

SPECIFICATIONS

Model LX-PA is
RoHS Compliant

Input Impedance 1000 ohms $\pm 10\%$
 Excitation Voltage..... 25 Volts max. AC or DC
 Output Impedance 0 to 1000 ohms

Linearity:

Ranges to 4.7" $\pm 1.0\%$ Full Scale
 10" to 25" range..... $\pm 0.5\%$ Full Scale
 30" to 50" range..... $\pm 0.25\%$ Full Scale
 Operating Temperature..... -15°C to 60°C

INSTALLATION INFORMATION

- 1** Unit mounts on surface shown in **FIG 1**.
 - 2** To maximize cable life, align transducer with moving element so that cable exits unit within 2° of vertical (with unit oriented as shown in **FIG 1**).
 - 3** Use **Table 1** to determine cable exit location relative to transducer mounting holes.
 - 4** Mount unit with two **6-32** or smaller machine screws or two **M3.5** or smaller metric machine screws.
- NOTE:**
- A** Place a flat washer under the head of each screw.
 - B** Torque **6-32** screws to **5 lb-in** maximum.
 - C** Torque **M3.5** screws to **0.56 N-m** maximum.
- 5** Solder electrical leads to potentiometer on transducer per the circuit diagram shown in **FIG 2** (designators in diagram correspond to pin designators on potentiometer). Output may be reversed by reversing the **+Vin** and **COM** leads. Electrical leads may be strain relieved by fastening to the potentiometer with a cable tie.
- 6 NOTE:**
- Units with **2"**, **2.8"**, **3.8"** and **4.7"** range employ a single turn potentiometer which has no stops. On these units the wire rope will extend to a total length of approximately 8" to 10". When extension beyond the specified measurement range occurs, the wiper of the potentiometer traverses a deadband after which the electrical output begins again.

CONNECTIONS

CIRCUIT DIAGRAM

FIG 2

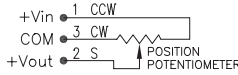

CONNECTION AT TRANSDUCER

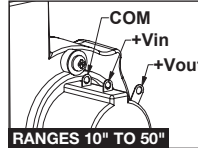
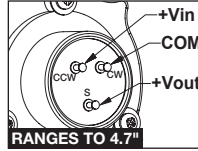

ELECTRICAL CABLE WIRING



NOTE: Shield is open at transducer

CABLE TO CABLE CONNECTOR

IF ORDERED CABLE TO CABLE CONNECTOR IS ATTACHED BY UNIMEASURE

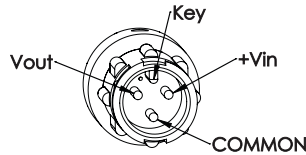

DIMENSIONAL INFORMATION

FIG 1

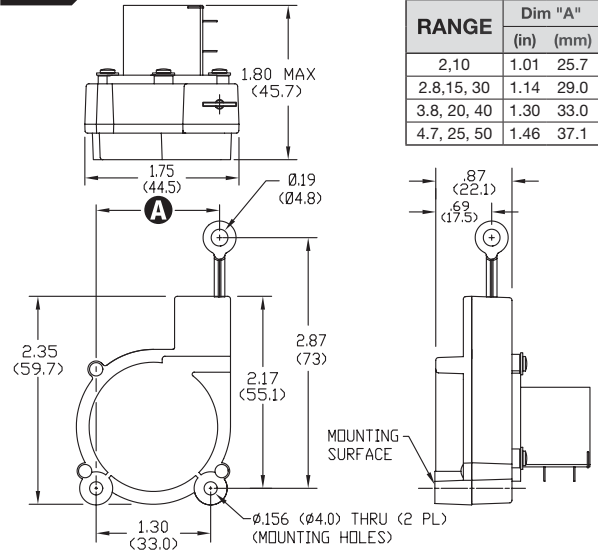

Dimensions in brackets are millimeters

TABLE 1

RANGE	Dim "A"	
	(in)	(mm)
2,10	1.01	25.7
2.8,15,30	1.14	29.0
3.8,20,40	1.30	33.0
4.7,25,50	1.46	37.1

MATING CONNECTOR WIRING DIAGRAM

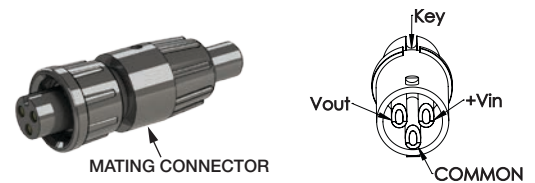

VIEWED FROM SOLDERING SIDE OF MATING CONNECTOR



4175 SW Research Way, Corvallis, Oregon, 97333
 Tel: (541) 757-3158 Fax (541) 757-0858

SENSITIVITY