

WIRE ROPE REPLACEMENT JX SERIES

1. Referring to Figure 1, remove the capstan cover by removing the four attaching screws.
2. With small blade type screwdriver, unclip the wiper cover shown in Fig. 1 and remove the two dust wipers.
3. Remove Mounting Base by removing four screws as shown in Fig. 2 and sliding Mounting Base away from mechanism.
4. Using a .050" hex driver, loosen the set screw securing the potentiometer and slide the potentiometer out of the main shaft (Fig. 4).
5. Referring to Fig. 3, with fingers restrain capstan from rotating and loosen screw on capstan. Remove wire rope. Allow retraction spring to slowly unwind capstan.
6. Feed new wire rope included in repair kit through the two guide holes in capstan housing.
7. Wind spring of transducer 17 revolutions by rotating capstan clockwise (as viewed from capstan end of transducer).
8. Feed wire rope through hole in surface of capstan (Fig. 3).
9. Using thin bladed tweezers, pull wire rope through slot in web of capstan and wrap around screw. Tighten screw to 50 oz-in. (0.35 N-m) to secure wire rope to capstan (Fig. 3).
10. Holding tension on wire rope, carefully let tension of spring reel the wire rope onto capstan.
11. Viewing shaft end of the potentiometer, rotate shaft counter-clockwise to stop.
12. Insert potentiometer into shaft of transducer, with anti-rotate arm aligned with alignment screw shown in Fig. 4.
13. Turn the potentiometer counter-clockwise until the anti-rotate rod is slightly past the anti-rotate slot (Fig. 4).
14. Tighten set screw, securing potentiometer to shaft.
15. Rotate potentiometer clockwise while deflecting anti-rotate rod enough to drop into slot in transducer housing (Fig. 4).
16. Place new wipers in wire rope guide area. Snap wiper cover into position.
17. Assemble Mounting Base to transducer body and torque fasteners to 50 in-oz. (0.35 N-m)
18. Install Capstan Cover and tighten screws finger tight.
19. Wire rope replacement is complete.

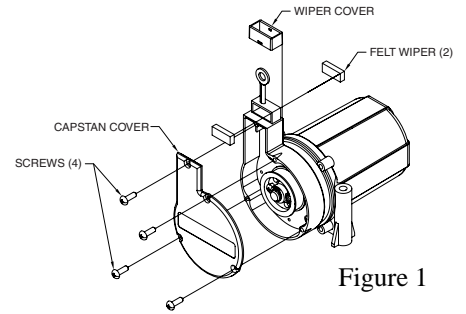

Figure 1

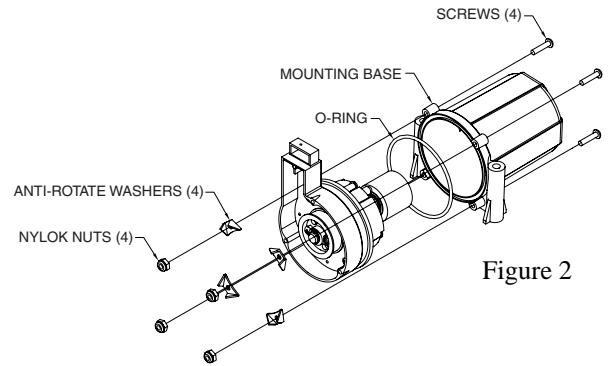

Figure 2

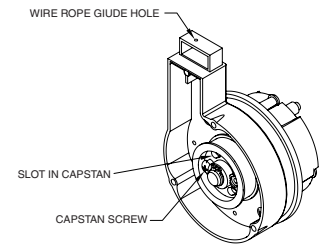

Figure 3

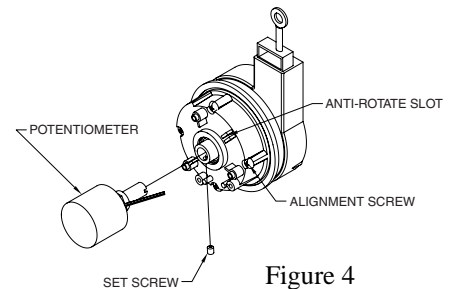

Figure 4